

# SET PALACE

## Countertop basin / cutable

### 81170.6



#### TECHNICAL DATA

Order no.	81170.6	Special specification	Charge 809 – 3 tap holes, 1 hole right for soap dispenser
Certified to	EN 14688		Charge 814 – 1 centre tap hole, 1 hole right for electronic valve unit to control the temperatur of the water and the flow rate
Dimensions	1500 x 380/510 mm	Weight	35,0 kg
Inside dimensions of the basin	700 x 350 mm	Mounting acc. excl.	2x Mounting set M10 x 140 mm, order no. 89988.2
Specification	Always to be fixed to the wall. Cut one-sided to 900 mm Charge 104 – 1 centre tap hole	Otherwise	When ordering the cut version use the order form for cutting
Special specification	Charge 108 – 3 tap holes Charge 109 – without tap holes Charge 111 – 1 centre tap hole, without overflow Charge 112 – without tap holes, without overflow Charge 136 – 3 tap holes, distance 8 inches Charge 158 – 3 tap holes, without overflow Charge 804 – 1 centre tap hole, 1 hole left for soap dispenser Charge 805 – 1 centre tap hole, 1 hole right for soap dispenser Charge 808 – 3 tap holes, 1 hole left for soap dispenser	Colours	see colour table

#### SPECIFICATION TEXT

Cutable countertop basin Laufen-PALACE, sanitary ceramic, EN 14688, dimensions 1500 x 380/510 mm, symmetric, 1 centre tap hole  
Special feature: overflow channel glazed, cutable to 900 mm, integreat-ed shelves  
Further options / accessories: Surface refinement LCC (only white), 3 tap holes, 3 tap holes distance 8 inches, without tap holes, without overflow, hole for soap dispenser, electronic valve unit to control water tempera-ture and flow rate, furniture  
Order no. 81170.6

#### TECHNICAL DRAWINGS / S 1 : 20

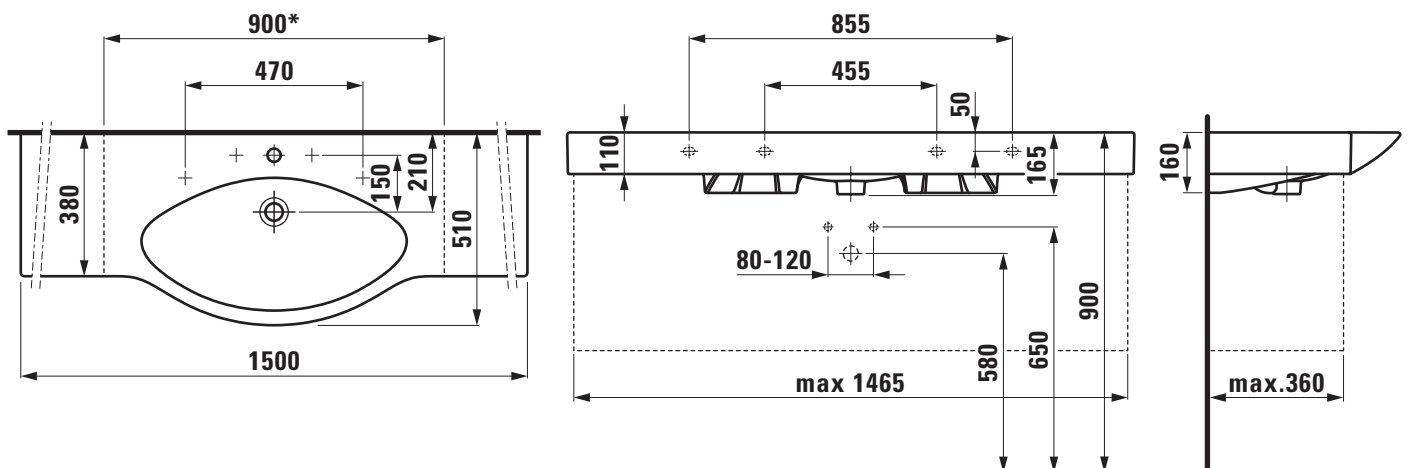

\* = minimum measure for cutting